

RainSky E



**DORN
BRACHT**

the SPIRIT of WATER

CONTENTS

- 03 Rain ☞
- 04 Rain modes ☞
- 08 Scenarios ☞
- 10 Light ☞
- 11 Fragrance ☞
- 12 Functions and operation ☞
- 14 Technical solutions ☞
- 17 Planning information ☞
- 18 Planning examples ☞
- 20 Planning tips for bathroom architecture ☞
- 25 Technical data ☞
- 26 Flow rate curves ☞
- 27 Scale drawings ☞
- 30 Planning checklist ☞
- 31 Programme ☞
- 33 Additional information ☞

TechniPlan RainSky E

RAIN SKY E TechniPlan gives you all the important information on every aspect of the natural rain experience in the bathroom. It contains all the technical content needed for planning, as well as detailed information on functionality and product descriptions. And as a stimulus for your own designs, we have included some planning examples.



RAIN

NATURAL RAINFALL HAS ALWAYS BEEN THE MOST SENSUOUS WAY TO SHOWER. With RAIN SKY E, you can now transpose this natural experience to your own refuge. So, for example, if you long for powerful, activating spring rain in the morning or a gentle, relaxing shower in the evening, there is now only one thing you need to do: start the relevant programme on the control panel.

RAIN SKY E BRINGS NATURAL RAINFALL INTO YOUR BATHROOM. The water comes from the ceiling without pressure and with great ease. The finely adjusted design of the shower nozzles produces raindrops perfectly in tune with nature herself and turns the shower into a sensory experience. With an extensive shower or a cloudburst directed at your head. The way the shower ends also follows nature's model: the rainfall reduces slowly to individual drops until the water finally peters out.

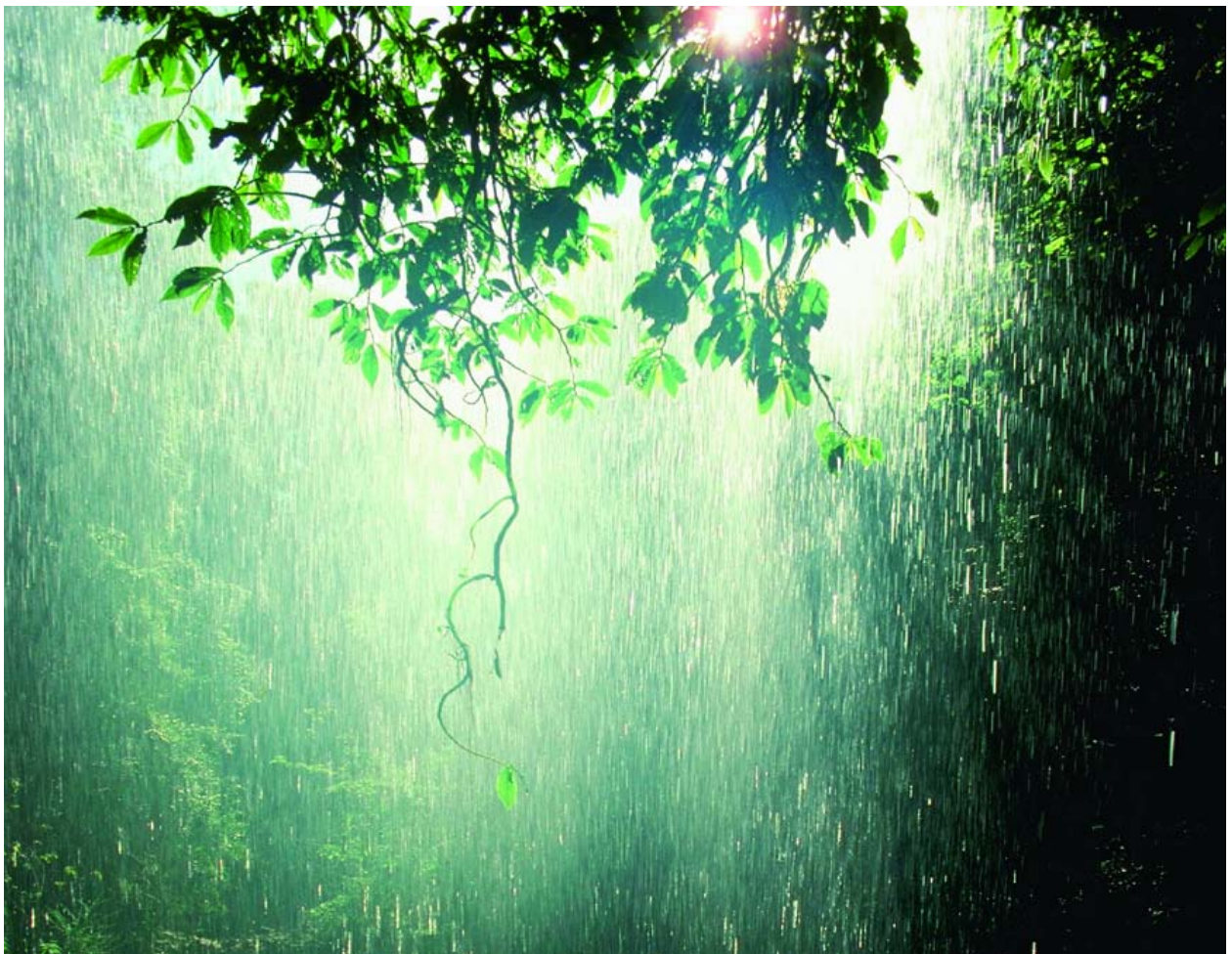

RAIN MODES

The three rain modes on the following pages can be selected either individually or in combination.

WITH THE RAIN CURTAIN the raindrops fall to the ground in a block. The arrangement of the nozzles follows the proportions of the human body: when you stand within the rain curtain, enjoy the unique feeling of being protected by a waterfall.

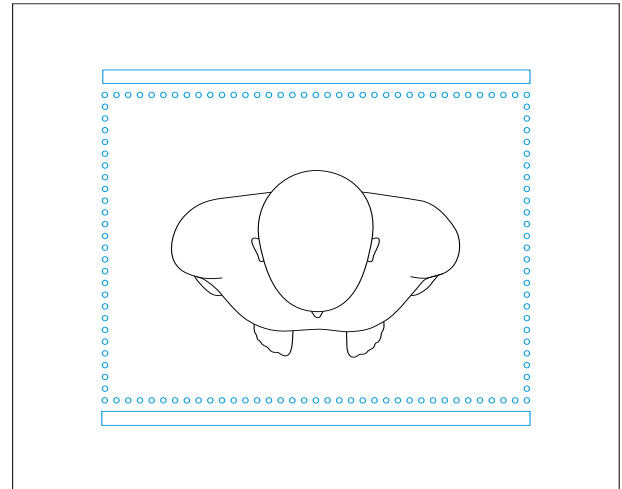

Rain curtain in relation to the user

THE BODY SPRAY pampers your shoulders and upper body with a shower. The nozzles are positioned so that you can enjoy the rain while still free to breathe and see, as your face is untouched.

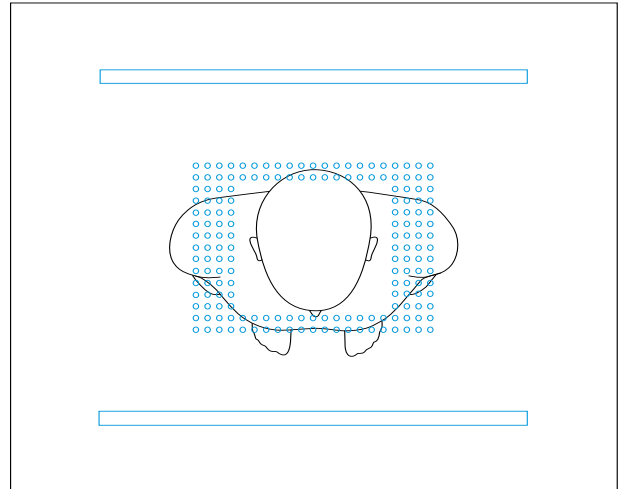

Body spray in relation to the user

THE HEAD SPRAY directs the rainfall onto your face, neck and hair. This directed use provides a familiar and thus relaxing shower experience.

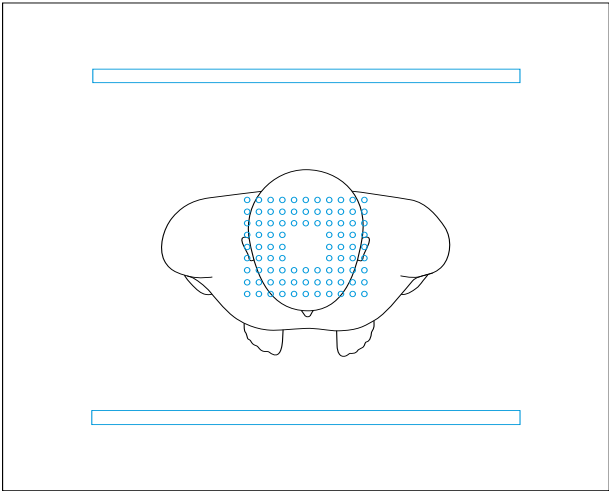

Head spray in relation to the user

THE COLD WATER MIST SPRAY sends out ultra-fine droplets of water that settle on your skin like dew. The agreeably cool bursts of mist stimulate your circulation.

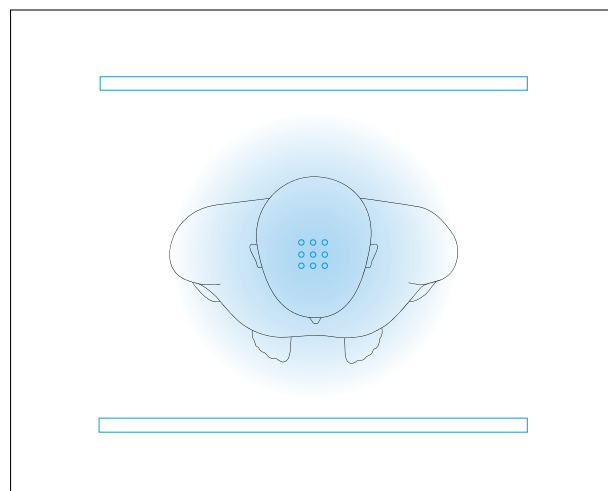

Mist spray in relation to the user

SCENARIOS

ALMOST BETTER THAN IN ITS NATURAL STATE, rainfall from RAIN SKY E – in fact, it is always exactly as you want it to be. The rule is: just enjoy it, there is nothing for you to think about. Because the electronic control panel does it for you: rain curtain, head and body sprays, mist spray, temperature, coloured light and fragrances are combined into three finely tuned scenarios, which are called RESTART, RELOAD or RETURN.



RESTART



RELOAD



RETURN

RESTART – RELOAD – RETURN

RESTART gently revives your life force energy. A shower of rain envelops your body: initially pleasantly warm and then invigoratingly cool. After the initial downpour, bursts of mist stimulate your circulation. The head and body sprays then join in and it becomes warm, before the rain curtain falls once again and the choreography comes to a conclusion. This activating scenario is accompanied by sunny, as well as cool mood colours and an aromatic fragrance.

RELOAD is a light shower that is simultaneously relaxing and stimulating. The body and head sprays start up one after the other: initially warm, then fresh, ultimately petering out with clinging softness. After a cool burst of mist, the body spray and rain curtain sprinkle your body with a warm shower. This process is repeated twice, to ensure lasting vitalisation. Sunny yellow to orange-coloured light accompanies the scenario; the inspiring fragrance has an invigorating effect.

RETURN is helpful for finding yourself when you return home. The rain curtain, head and body sprays envelop your body in water that is at just the right temperature. Stress and everyday life roll away, your mind relaxes. The constantly agreeable temperature and the lack of mist intervals promote a feeling of peace and security. Colours change between energetically warm shades of orange and cool, calmer blue spectrums. An earthy, balmy fragrance underlies the virtually meditative scenario.

RESTART

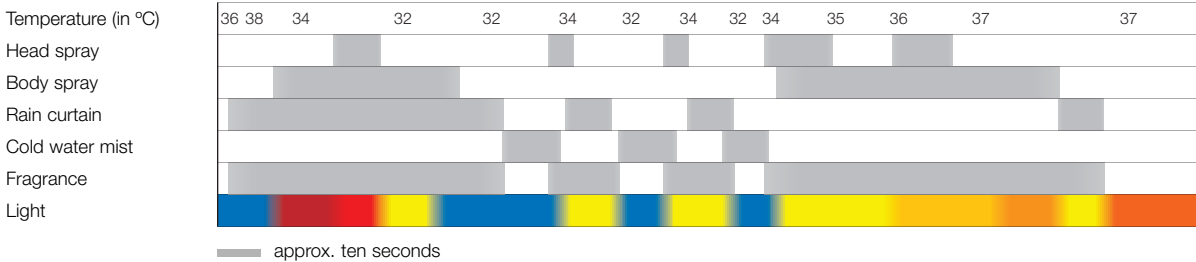

RELOAD

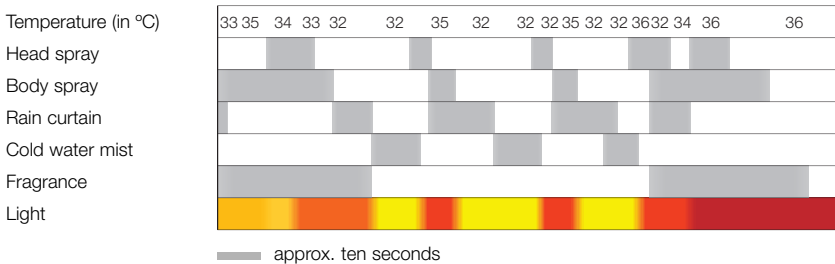

RETURN

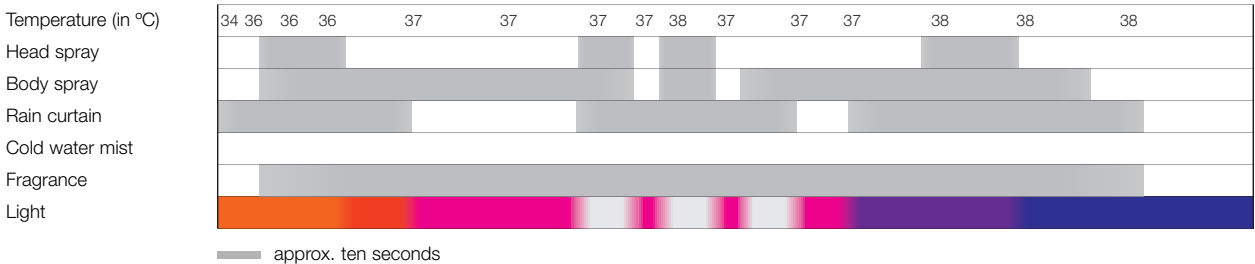

Scenario choreography (colours are not obligatory)

LIGHT

FROM ENERGETICALLY WARM SHADES TO CALMINGLY COOL ONES – the integrated light strips ensure that there are always atmospheric colours to match the mood. Automatic light control varies colour and intensity independently, in tune with the chosen scenario. White ambient light automatically comes on after the scenario has run its course, although it can also be selected manually by the light button. A safety circuit ensures that the lighting switches off after 60 minutes.

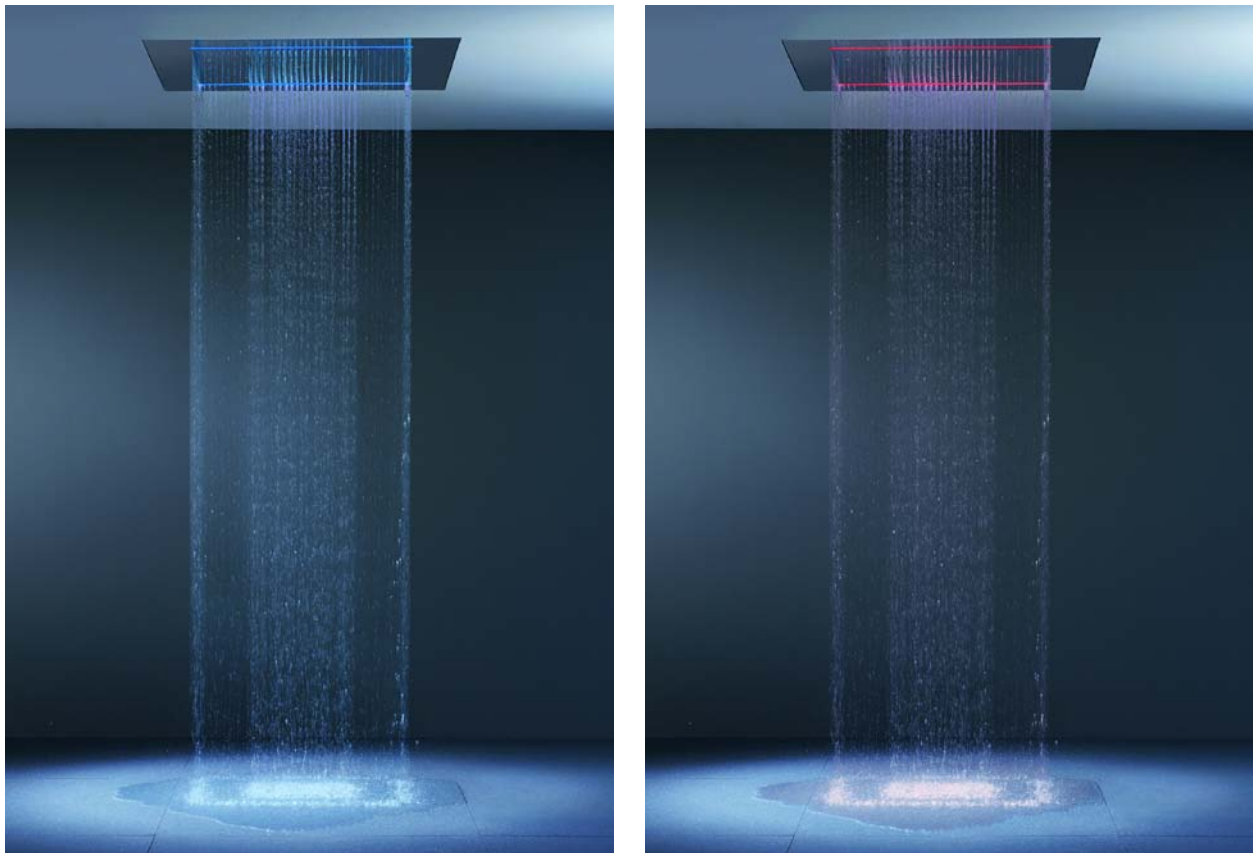

RainSky E with different lighting

FRAGRANCE

DIFFERENT FRAGRANCES INTENSIFY THE SHOWER EXPERIENCE, by acting on the senses right through to the subconscious. The fragrance module exudes aromas to further support the particular scenario. There are two fragrance nozzles in the rain panel through which the fragrant air reaches the shower separately from the water. The intensity of each individual fragrance can be regulated in three levels (low/average/high). Of course, the fragrance can also be switched off completely.

THREE FRAGRANCES:

RESTART pampers you with eucalyptus and mint: it has an invigorating and activating effect.

RELOAD smells of green tea and mandarin: it has a revitalising and inspiring effect.

RETURN flatters you with lavender and bergamot: it has a calming and relaxing effect.

RESTART

peppermint,
eucalyptus

RELOAD

lemon, mandarin,
grapefruit frappé,
orange

RETURN

lavender, peach,
bergamot, apple

rosemary,
lavender oil

apple blossom,
lotus flower, green tea,
peony, lavender

jasmine, tuberose,
iris, lily of the valley

pine needles,
lavandin absolute

tonka beans,
maté

patchouli, cedarwood,
musk

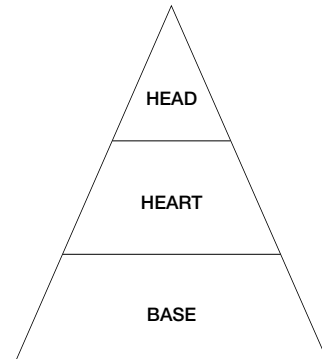

Combination and composition of the fragrances

FUNCTIONS AND OPERATION

OPERATION OF RAIN SKY E IS ULTRA CONVENIENT. Press the volume button to prepare RAIN SKY E. The water is still cold when, after a three-second delay, it runs from the pipes. Once the water temperature reaches 38°C, the green LED stops flashing and stays on permanently. The RESTART, RELOAD or RETURN scenarios are now ready to start. The volume button regulates the amount of water within the range prescribed by the electronics and the temperature button regulates the warmth of the water. You only have to turn them. To prevent the user accidentally setting too high a temperature for the water, scald protection limits the maximum temperature to 42°C. To deliberately exceed the temperature limit, you first have to press and release the temperature button. You must then press it again within three seconds and by simultaneously turning it, you can set the temperature you require.

If you do not wish to make use of the scenarios, the rain curtain, head spray, body spray, mist, light and hand shower functions can also be operated individually by using the relevant buttons.

Should you require more detailed information, this can be found in the manual [☞](#).

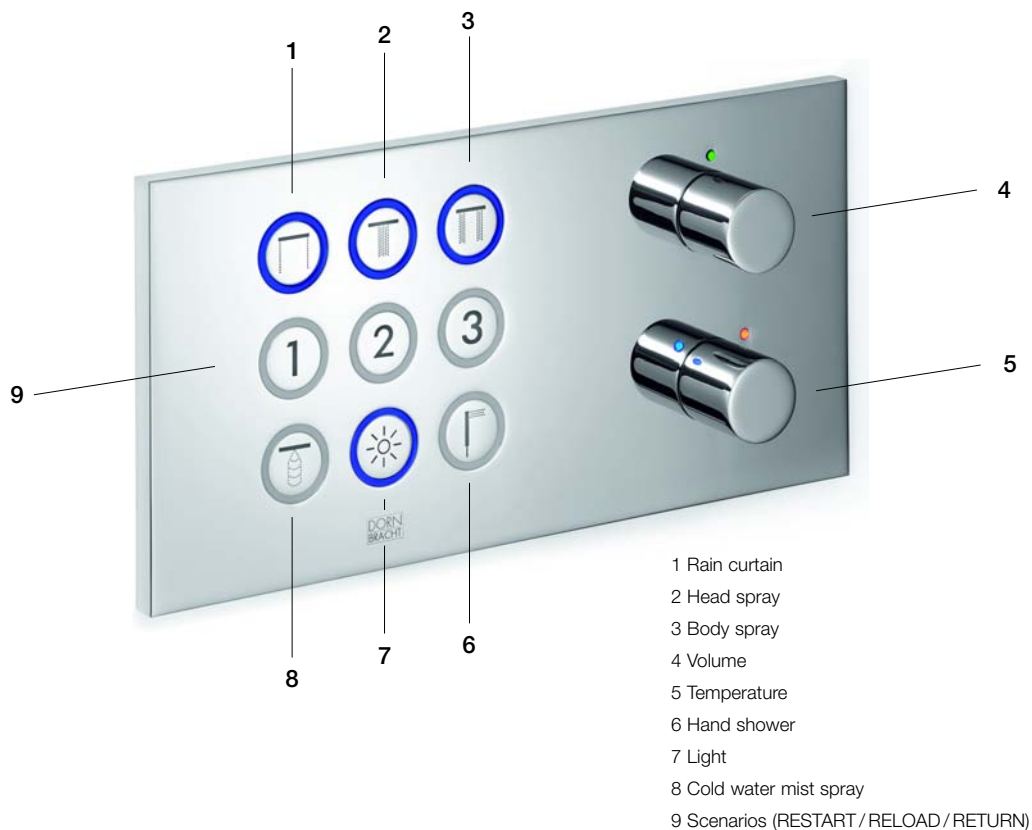

Operation is by electronic control

THE COVER PLATE, once installed, fits harmoniously into the architecture. It is the natural interface between the rainfall experience and the technology inside and unites all the functions.

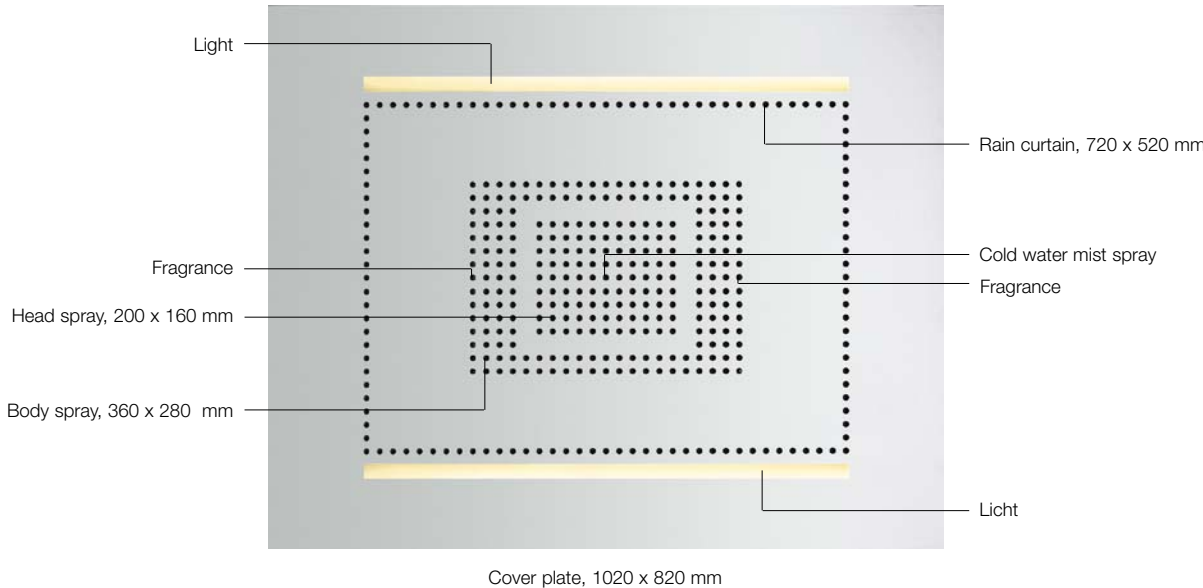

Cover plate with four flow panels for the different rain modes

TECHNICAL SOLUTIONS

SHOWER BOX

The shower box is the intelligent core of RAIN SKY E. This is where the electronic thermostat valve, the magnetic valves and the fragrance and mist nozzles are located with the pressure regulator.

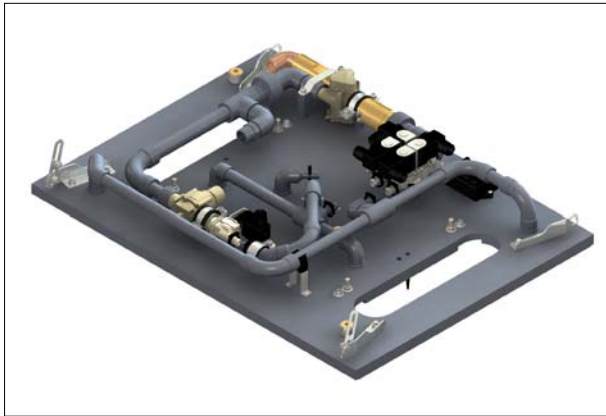

NOZZLES

The nozzles in RAIN SKY E have been specifically developed to shape raindrops. They have a sophisticated anti-scale system, which allows deposits to be removed simply with a wipe. They can be replaced individually for uncomplicated maintenance.



EASY INSTALLATION

Ceiling module installation is both convenient and simple. Whether LED light strips, control cables, terminals, power pack or shower box: all components are pre-installed in the enclosure.



SAFETY CIRCUIT

Within RAIN SKY E, independent safety circuits in the electronics ensure that the water always emerges at the correct temperature. There is also scald protection that takes effect from 42°C, to ensure that you do not accidentally set too high a water temperature with the temperature button. Should the water become too hot despite this, RAIN SKY E will immediately close all outlets and return to its idle state. Once the water has cooled down, the shower is again ready for action. Likewise if the power fails, RAIN SKY E shuts down automatically.

WATERPROOFING

To stop the brickwork or the dry wall being affected by water, the tiler embeds the proven and reliable KERDI waterproof packing into the alternative seal under the tiles. This guarantees that the wall is securely waterproofed. Additional protection is provided for the electronic control on the control panel, to stop moisture getting in.



FRAGRANCE MODULE

The fragrance module, with its fragrance pump and control unit for the aromas, comes with three fragrance containers for the respective scenarios. Aromas are only released during the scenarios. You can test and modify the intensity of the individual fragrances for the particular scenario by keeping the temperature button pressed and simultaneously pressing one of the programme buttons. The fragrance module in the scenario must be active. Once the fragrance in a container is used up (for private use, the contents last about one year), the LED ring of the particular scenario flashes, prompting replacement of the fragrance container. The fragrance module is installed in an easily accessible area outside the wet zone. This ensures that fragrance containers can easily be replaced. More detailed information on regulating the intensity of the fragrance and on replacing and reordering the fragrance containers can be found in the manual. [☞](#).



PLANNING INFORMATION

PLUMBING

Supply connection for RAIN SKY E (hot and cold water)	2 x DN 20
Outlet for hand shower	1 x DN 15

WATER HARDNESS

Recommended water hardness: 6–7° dH. If your water is harder, install a water softening system that uses the ion exchange principle into the feed pipes.

HOT WATER STORAGE

For the optimum choice of hot water storage device – taking into consideration additional drawing-off points and the frequency with which RAIN SKY E is used – the specific demand needs to be assessed. Recommendation: storage capacity of at least 500 l.

FLOOR DRAINAGE

The optimum size for floor drainage – taking into consideration the flow rate from RAIN SKY E and other consumers in the shower – needs to be calculated on an individual basis. Recommendation: connected rating 1.5 l/s, drainage pipe DN 70.

ELECTRICAL

Earth-leakage circuit-breaker	30 mA, provided by customer
Feed pipe	3 x 1.5 mm ² , NYM at least 2.25 m above top edge of finished floor
Electrical bonding (RAIN SKY E ceiling module and control panel)	2 x 4 mm ²

Water and electronics installations must comply with relevant international and local regulations and be implemented by authorized professionals.

INSTALLATION INFORMATION

The customer must provide separate cutoffs for the hot and cold water pipes as well as an input filter in the water feed.

Recommended spacing between bottom edge of RAIN SKY E and the head of the tallest user, 400–1000 mm.

RAIN SKY E is installed in a suspended ceiling.

Recommendation: Provide a continuous shadow gap (5 mm) between the RAIN SKY E cover plate and the ceiling.

PLANNING EXAMPLES

PLEASE NOTE: the fragrance module is installed outside the wet zone. The customer must provide a separate cutoff for the hot and cold water pipes, as well as an input filter in the water feed.

Safety zones to comply with DIN VDE 0100, PART 701. Please conform to national statutory regulations, where different.

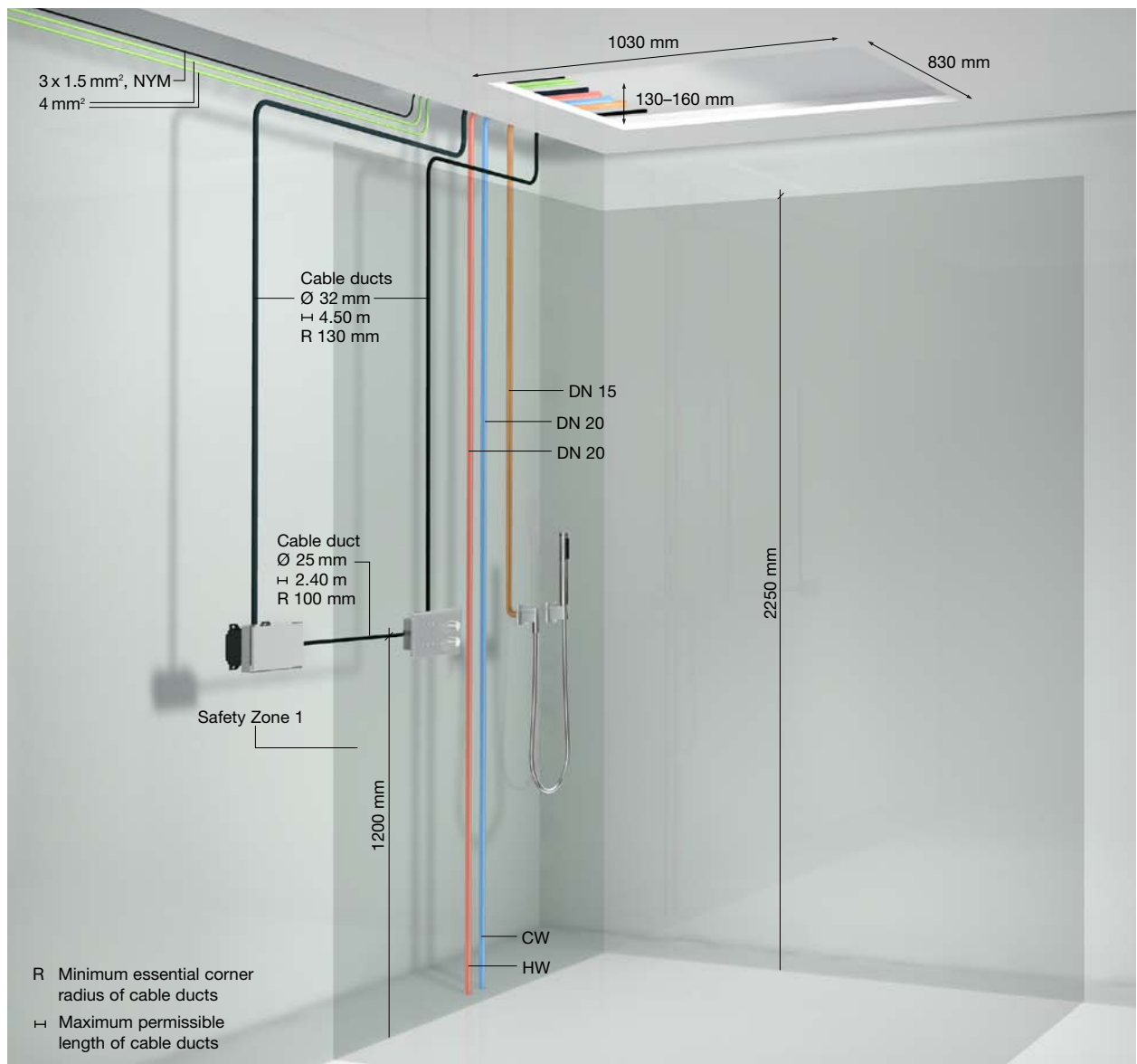

PLEASE NOTE: the fragrance module is installed outside the wet zone. The customer must provide a separate cutoff for the hot and cold water pipes, as well as an input filter in the water feed.

Safety zones to comply with DIN VDE 0100, PART 701. Please conform to national statutory regulations, where different.

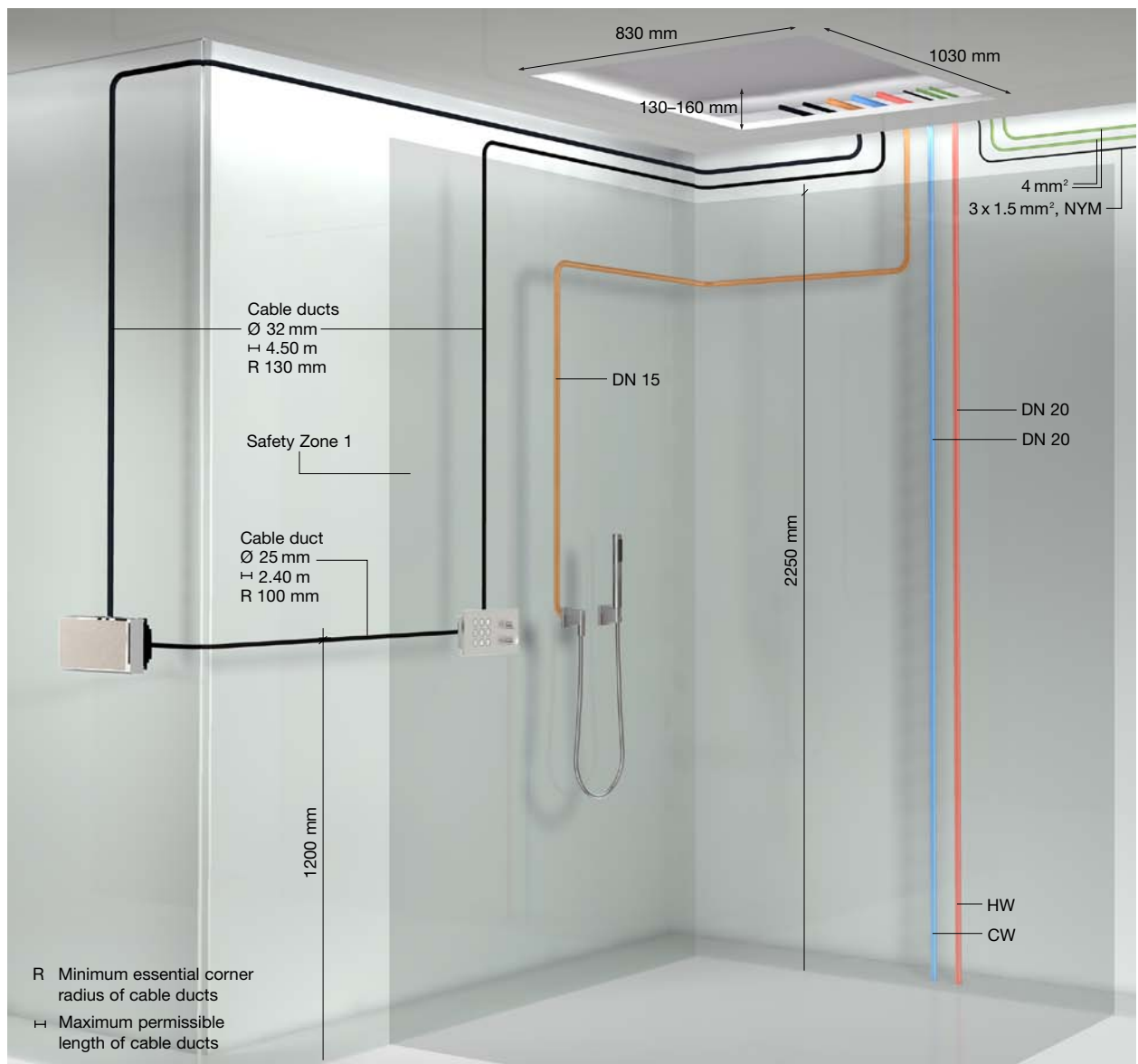

PLANNING TIPS FOR BATHROOM ARCHITECTURE

SHOWER SITUATION 01: NICHE SOLUTION

You choose whether to attach all the installations to wall A or wall C. The fragrance module must be installed outside the wet zone, if possible on the same side as the control panel. Position the panel in such a way that RAIN SKY E can be operated from outside, to clean the wet zone with the hand shower, for example.

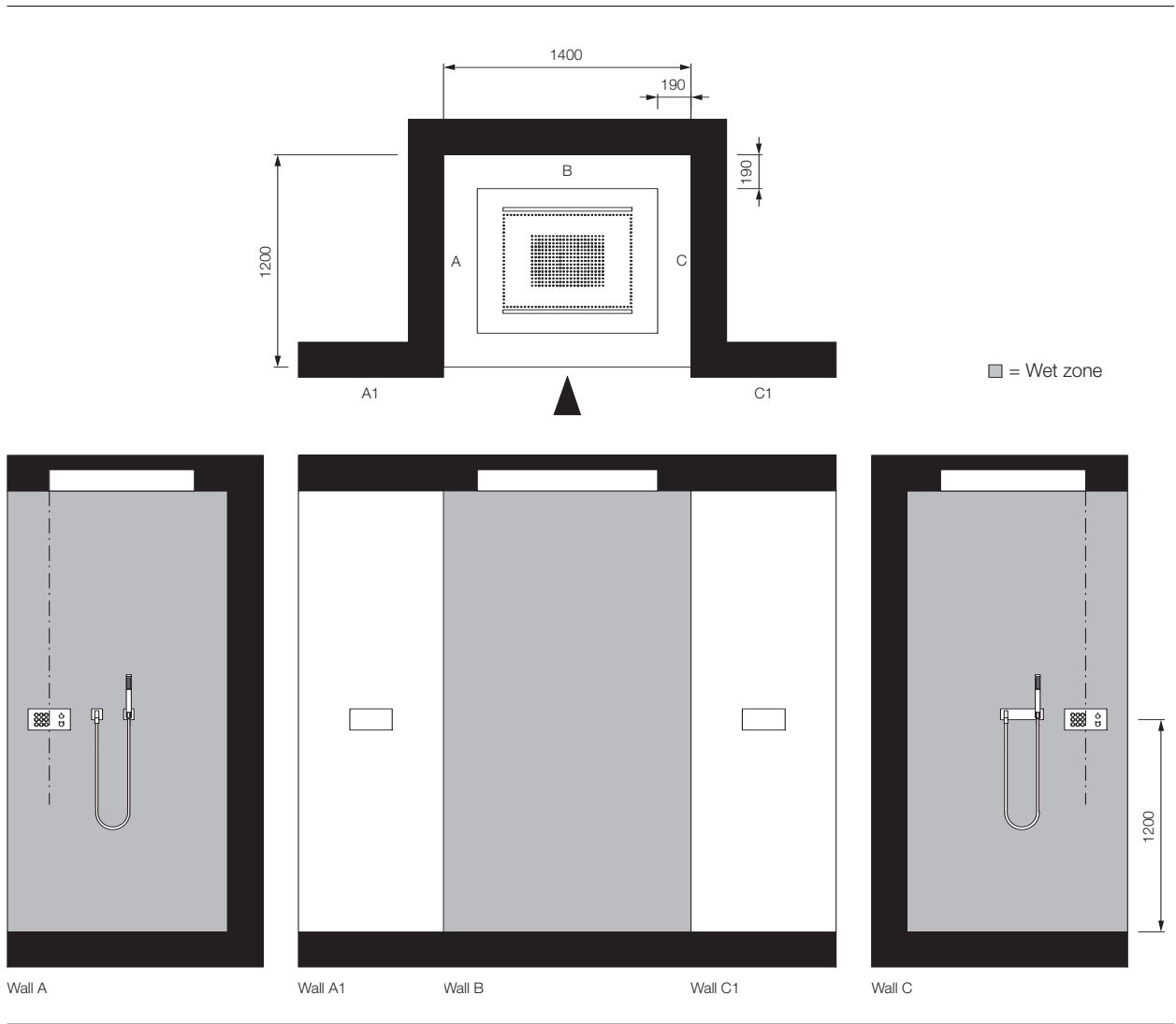

SHOWER SITUATION 02: CORNER SOLUTION WITH SIDE ACCESS

All the installations are located on wall A. Here too, the fragrance module is kept apart from the wet zone. The control panel is attached so that it can be operated from outside the wet zone, making it possible, for example, to clean the shower area with the hand shower.

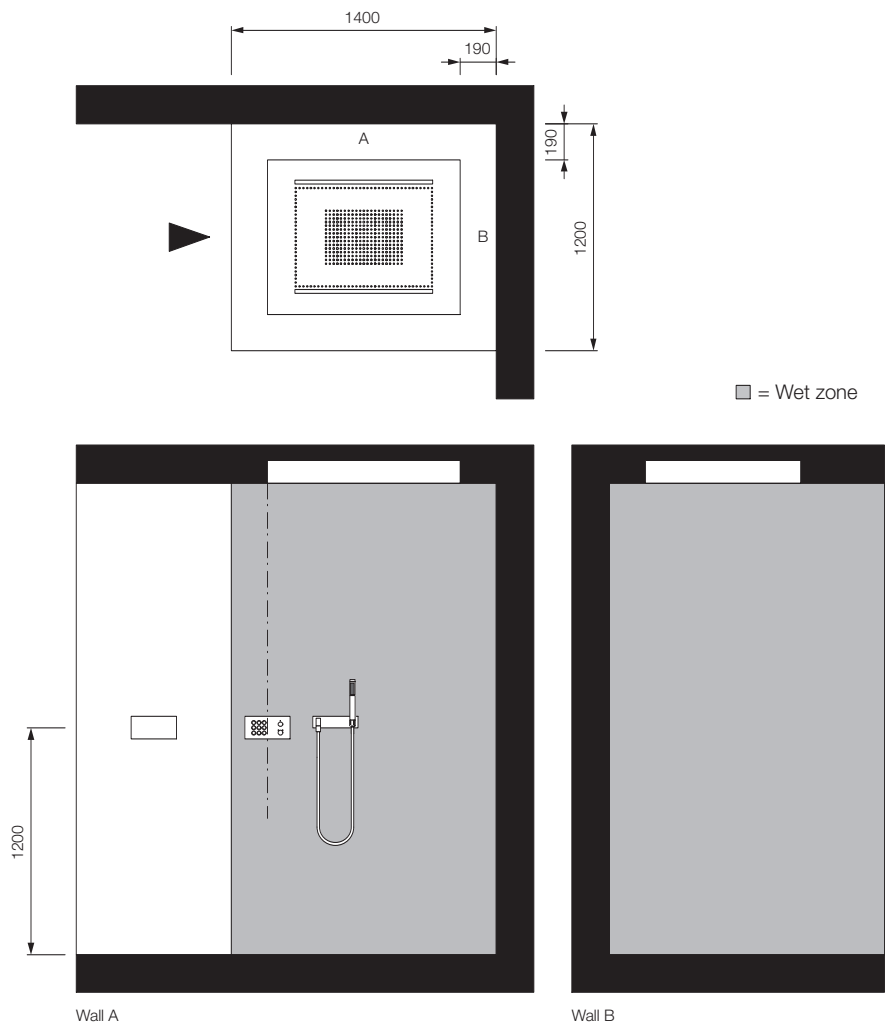

SHOWER SITUATION 03: COVERING WALL ON ONE SIDE

All the installations are on one wall, with the fragrance module outside the wet zone. If possible, it should be placed on the same side as the control panel. For operation outside the wet zone and the opportunity to clean the shower area with the hand shower, the control panel and the hand shower would have to be positioned accordingly.

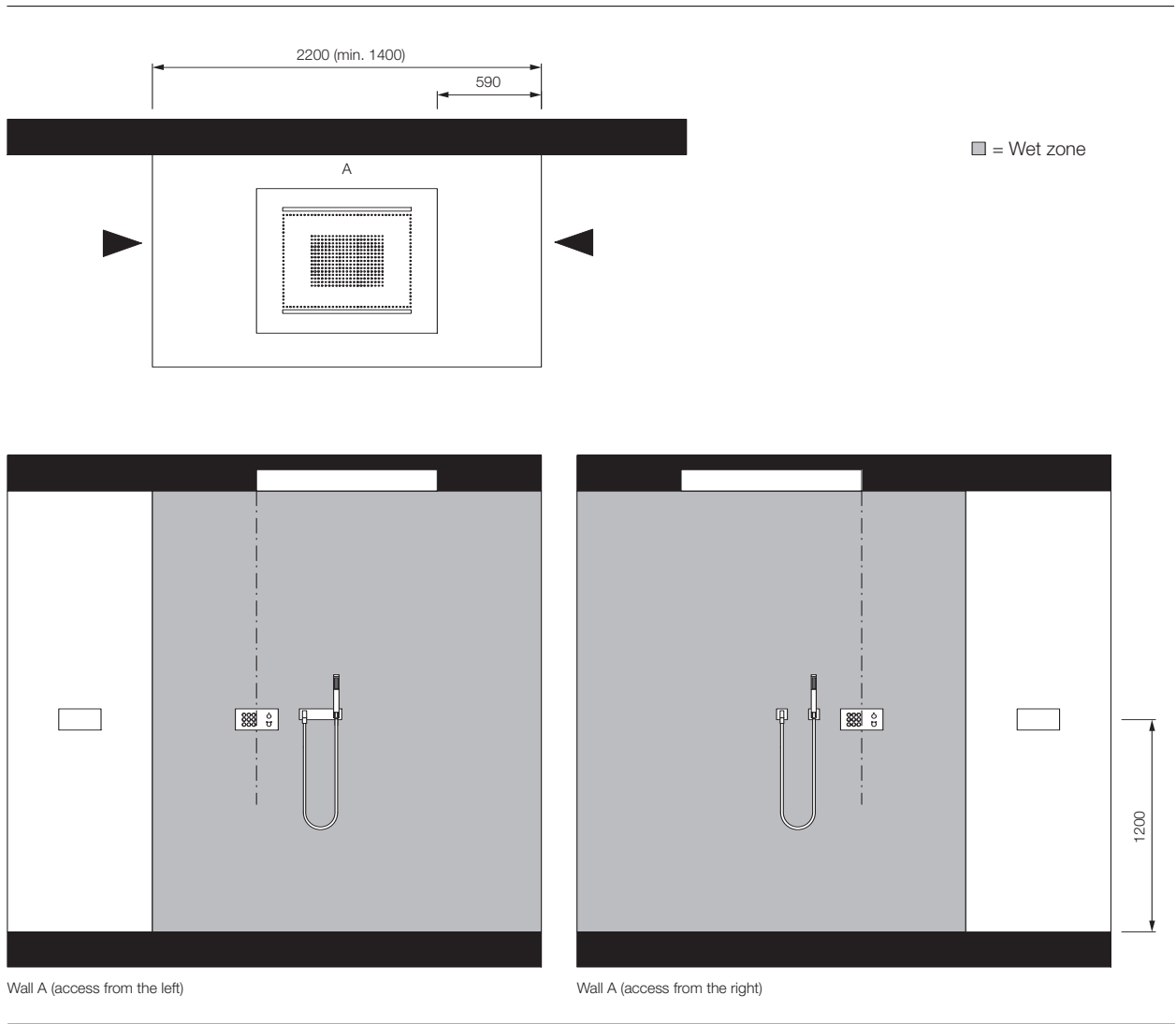

SHOWER SITUATION 04: COVERING WALL ON TWO SIDES

As in shower situation 03, all the installations are on one wall. The fragrance module is located outside the wet zone. If possible, it should be placed on the same side as the control panel. For operation outside the wet zone and the opportunity to clean the shower area with the hand shower, the control panel and the hand shower would have to be positioned accordingly.

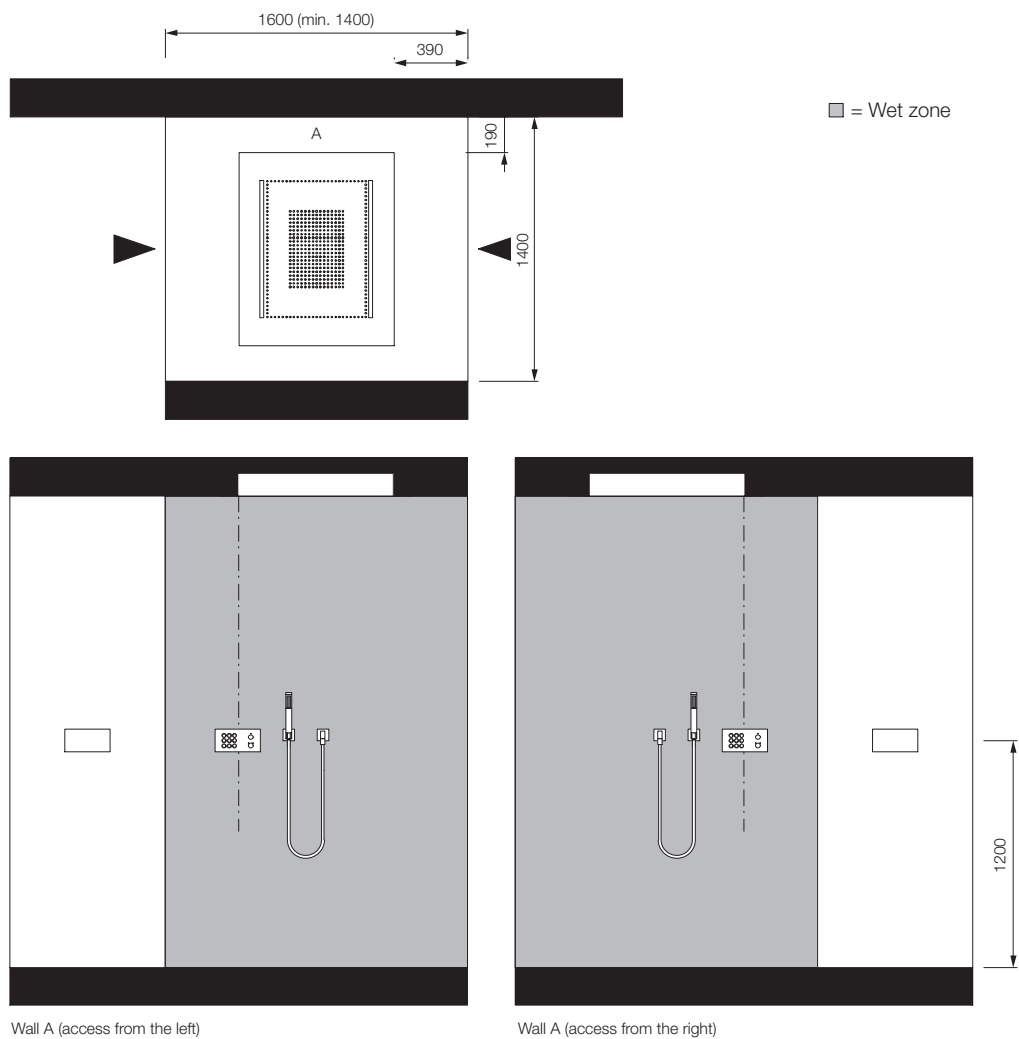

SHOWER SITUATION 05: ANYWHERE IN THE ROOM

All the installations are attached to a room unit. To position the fragrance module outside the wet zone, it can be attached to the back of the room unit, for example.

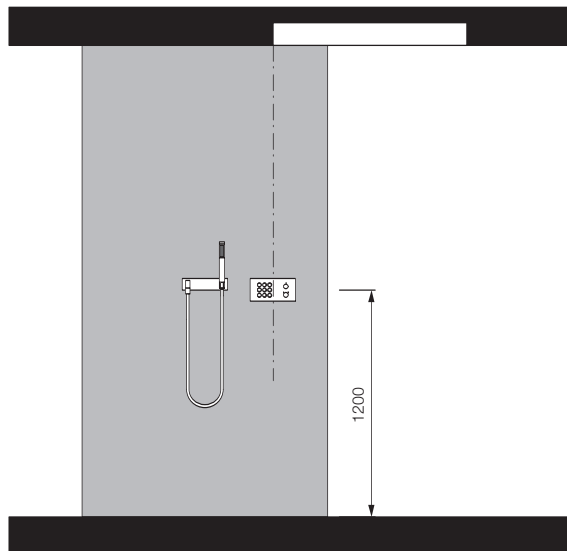
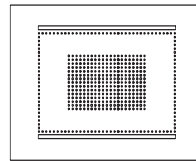

TECHNICAL DATA

PLUMBING

RAIN SKY E FLOW RATE AT 3 BAR FLOW PRESSURE

Head spray	18 l/min
Body spray	18 l/min
Rain curtain	18 l/min
Total	35 l/min
Hand shower	11 l/min
Mist	1 l/min

WATER CONSUMPTION PER SCENARIO

RESTART	Total: approx. 80 litres at 38 ° C
RELOAD	Total: approx. 50 litres at 38 ° C
RETURN	Total: approx. 110 litres at 38 ° C

FLOW PRESSURE

Minimum flow pressure	2.5 bar
Maximum flow pressure	4.0 bar
Maximum difference in flow pressure between hot and cold water	1.0 bar

TEMPERATURE

Maximum hot water temperature	+60 ° C
Minimum hot water temperature	+50 ° C
Recommended cold water temperature range	+10 ° to +20 ° C

WEIGHT

Ceiling module	60 kg
----------------	-------

ELECTRICAL

Electricity supply	230 V, 50–60 Hz, 200 Watt
Power consumption in stand-by mode	22 Watt
Control cable for ceiling module control panel (hardwired in ceiling module)	5 m in scope of supply
Control cable for fragrance module control panel (hardwired in fragrance module)	3 m in scope of supply
System of protection	IP 55
Safety marks	TÜV (type approval), GS, CE

FLOW RATE CURVES

RAIN SKY E

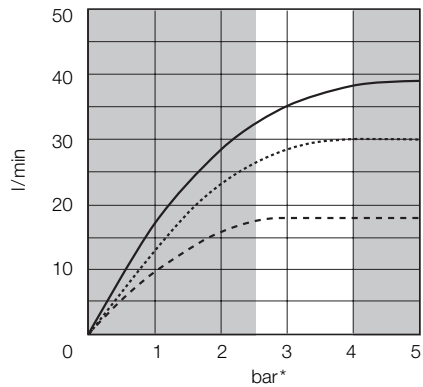

- Recommended flow pressure
- Total flow rate
- Head spray/body spray flow rate
- Flow rate per rain mode

BAR-TYPE HAND SHOWER IN COMBINATION WITH RAIN SKY E

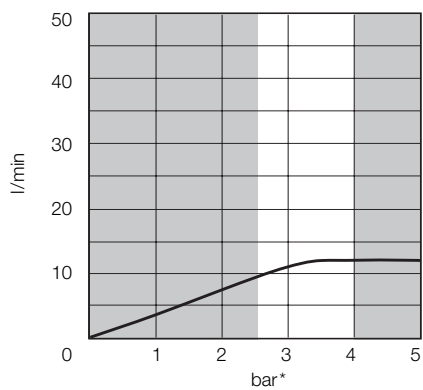

- Recommended flow pressure
- Bar-type hand shower flow rate

*Flow pressure

ELECTRONIC CONTROL

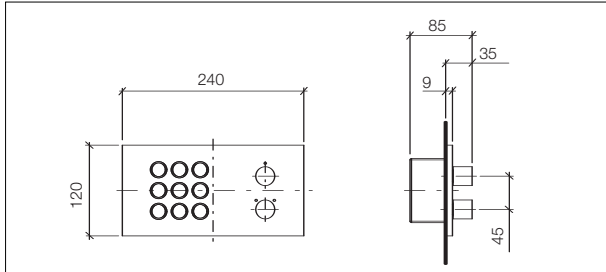

FRAGRANCE MODULE

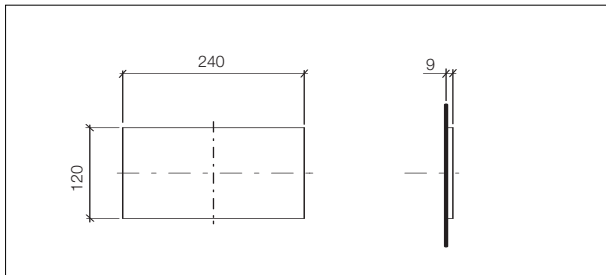

WALL INSTALLATION BOX FOR FRAGRANCE MODULE AND ELECTRONIC CONTROL

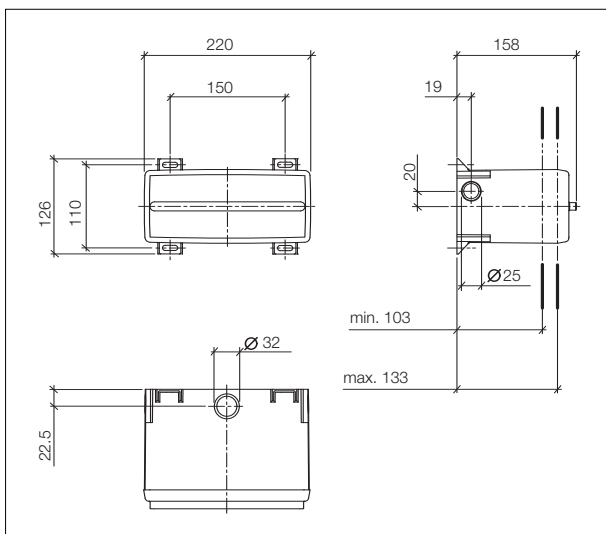

Scale 1:10 / specifications in mm

**COMPLETE HAND SHOWER SET
WITH INDIVIDUAL ROSETTES**

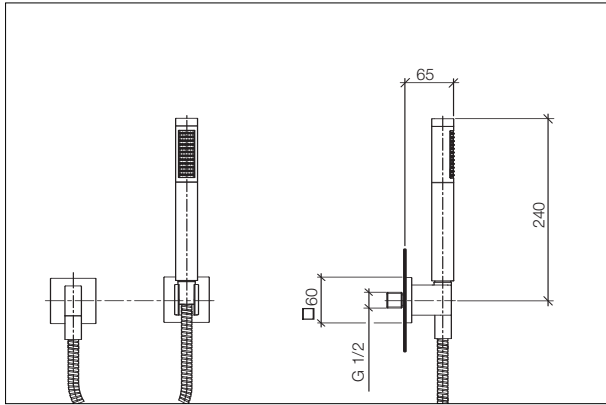

**COMPLETE HAND SHOWER SET
WITH COVER PLATE**

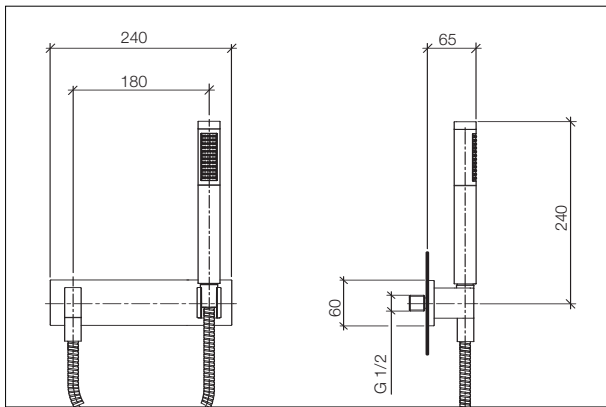

Scale 1:10 / specifications in mm

PLANNING CHECKLIST

- Ascertain water hardness, include water softening system, recommended: 6–7 ° dH
 - Water heater with at least 500 l storage capacity/calculate on an individual basis
 - Floor drainage connected rating 1.5 l/s, drainage pipe DN 70/calculate on an individual basis
 - Minimum flow pressure 2.5 bar/maximum flow pressure 4.0 bar
 - Maximum difference in pressure between hot and cold water: 1.0 bar
 - Maximum hot water temperature: 60 ° C
 - Minimum hot water temperature: 50 ° C
 - Clarify ceiling statics (weight of RAIN SKY E ceiling module: 60 kg)

 - Control panel operation from shower area and from outside shower area.
Position wall box accordingly
 - Complete hand shower set within reach of control panel
 - Fragrance module attached outside wet zone/position wall box accordingly
 - Maximum spacing (special lengths on request)
Ceiling module – control panel and ceiling module – fragrance module: 4.5 m
Provide wire pull for cable duct (outer diameter 32 mm, minimum radius 130 mm)
Control panel – fragrance module 2.4 m, provide wire pull for cable duct
(outer diameter 25 mm, minimum radius 100 mm)
 - Supply pipes (cold water + hot water) 2 x DN 20, outlet for hand shower DN 15
 - Provide pre-seals in supply pipes
 - Provide filters in supply pipes

 - RAIN SKY E ceiling module, minimum height 2.25 m above top edge of finished floor
 - Supply voltage 230 V, 50–60 Hz, 200 W
 - Feed pipe NYM 3 x 1.5 mm²
 - Individual protection by 30 mA earth-leakage circuit breakers
 - Electrical bonding (4 mm²) to ceiling module and to control panel

 - Ceiling with continuous 5 mm shadow gap to RAIN SKY E
 - Clarify language version for operating manual and quick reference guide
-

PROGRAMME



RainSky E rain panel for ceiling installation

head spray 200 x 160 mm, 90 nozzles / body spray 360 x 280 mm, 142 nozzles / rain curtain 720 x 520 mm, 124 nozzles / cold-water mist spray 40 x 40 mm, 9 nozzles / 2 fragrance nozzles
 pre-fitted stainless steel enclosure 990 x 790 x 128 mm / cover plate, stainless steel, 1020 x 820 x 2 mm
 electronic thermostat valve / 4-way magnetic valve / magnetic valve with pressure regulator / 2 light gaps, RGB LED lights / supply voltage 230V, 50-60 Hz, 200 W / control cable 7 x 0.25 mm², length 5 m / control cable 10 x 0.75 mm², length 5 m / 2 hinges and safety chains / 4 x M 10 heavy-duty bolts / 2 flexible connection hoses, 3/4" female thread connection (cold/hot connection) / 1 flexible connection hose, 1/2" female thread connection (complete hand shower set outlet)

41 200 979-85 polished high-grade steel
41 200 979-86 matt high-grade steel



Electronic control for RainSky E

Exposed trim parts
 control panel with electronic controller, 240 x 120 mm for controlling RainSky E (**41 200 979-FF**), a hand shower (e.g. **27 808 980-FF**) and the fragrance module (**42 600 979-FF**)
 tile guard template made from stainless steel

Only for combination with **41 200 979-FF**

42 700 979-00 polished chrome
42 700 979-06 platinum matt



Required miscellaneous

Wall installation unit

Concealed rough parts
 dust cover / anti-water packing / attachment set

35 200 970 90



Fragrance module for RainSky E

Exposed trim parts
 cover plate 240 x 120 mm / fragrance distributor with fragrance pump
 3 fragrance containers (RESTART/RELOAD/RETURN)
 control cable, 8 x 0.5 mm², length 3 m / 3 fragrance hoses, length 5 m

Only for combination with **41 200 979-FF** / **42 700 979-FF**

42 600 979-00 polished chrome
42 600 979-06 platinum matt



Required miscellaneous

Wall installation unit

Concealed rough parts
 dust cover / anti-water packing / attachment set

35 200 970 90



Complete hand shower set with individual rosettes

wall bracket
bar-type hand shower with anti-scale system and back flow preventer
3/8" x 1/2" x 1250 mm shower hose with turning cone
1/2" wall elbow with back flow preventer
3/8" shower outlet
rosette 60 x 60 mm

Intrinsic protection against back flow.

27 808 980-00 polished chrome
27 808 980-06 platinum matt



Complete hand shower set with cover plate

wall bracket
bar-type hand shower with anti-scale system and back flow preventer
3/8" x 1/2" x 1250 mm shower hose with turning cone
1/2" wall elbow with back flow preventer
3/8" shower outlet
cover plate 240 x 60 mm

Intrinsic protection against back flow.

27 818 980-00 polished chrome
27 818 980-06 platinum matt



Spare RESTART fragrance container

for RainSky E fragrance module 42 600 979-FF

12 401 979 90



Spare RELOAD fragrance container

for RainSky E fragrance module 42 600 979-FF

12 402 979 90



Spare RETURN fragrance container

for RainSky E fragrance module 42 600 979-FF

12 403 979 90

Aloys F. Dornbracht GmbH & Co. KG Armaturenfabrik Köbbingser Mühle 6 D-58640 Iserlohn
Telefon +49 (0)2371 433-470 Fax +49 (0)2371 433-232 E-Mail mail@dornbracht.de www.dornbracht.com

Photography Thomas Popinger
Product Design Sieger Design
Concept & Creation Meiré und Meiré
Product Photography Fotostudio Tölle

Model, programme and technical changes and errors excepted.

The latest version can be found at www.dornbracht.com
As at: October 2007